

A how-to guide and general information to help you get the most out of this file.

How to Add Your Design ?

After your purchase & download this graphic, you will find 10 Photoshop .psd files which contain all your text mockups.

In each one of the Photoshop files, you will find the following layers.

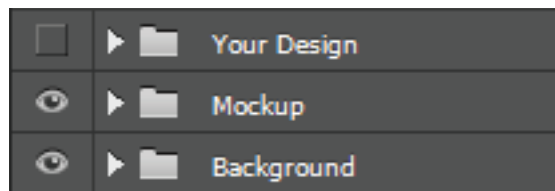

To add your design, go to the first group layer “Your Design” and expand its content by ticking the arrow next to it as shown in the screenshot.

Under this layer, you will find 2 layers that represent each of the 2 text lines in this graphic. Right click on a layer then click “edit contents”, a new window will open, edit the text in this window then save the file (*note: you can add any smart object shape instead of text*). Now go back to your main file, you will find that the design is updated. Repeat this procedure for the other text line layers.

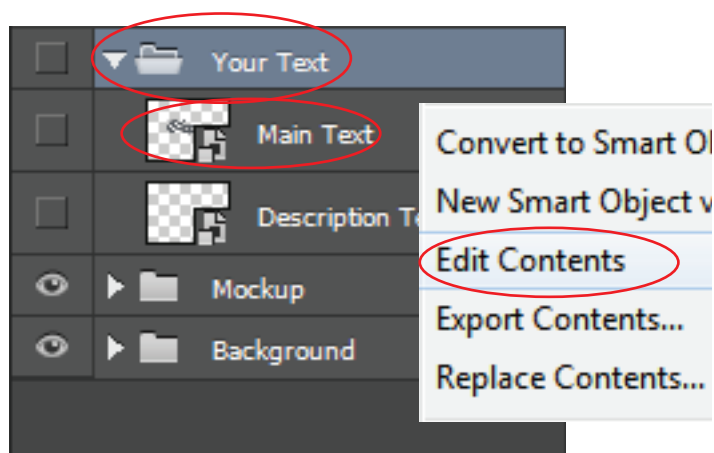

Fonts used ?

Only free fonts were used in the graphic. You can download them at the following links :

Harbell Personal :

<http://www.dafont.com/harbell.font>

Bira Personal Font:

<http://www.dafont.com/bira.font>

Grand Hotel:

<http://www.fontsquirrel.com/fonts/grand-hotel>

Font Zulia Pro:

<http://www.red-article.com/post/83618544031/free-font-zulia-pro>

Lobster:

<http://www.dafont.com/lobster.font>

Smudger Let:

<http://www.fontpalace.com/font-details/Smudger+LET+Plain1.0/>

♦ ♦ ♦ ♦ ♦ ♦ ♦

thank you.